

**Accommodation**

- 1 Reception
- 2 12 Person Boardroom
- 1 Training Room (2 Meeting Rooms)
- 2 5 Person Meeting Room
- 2 Office
- 1 Comms Room
- 2 Copy Area
- 1 Teapoint
- 96 Open Plan Workstations

Floor plans for indicative purposes only.

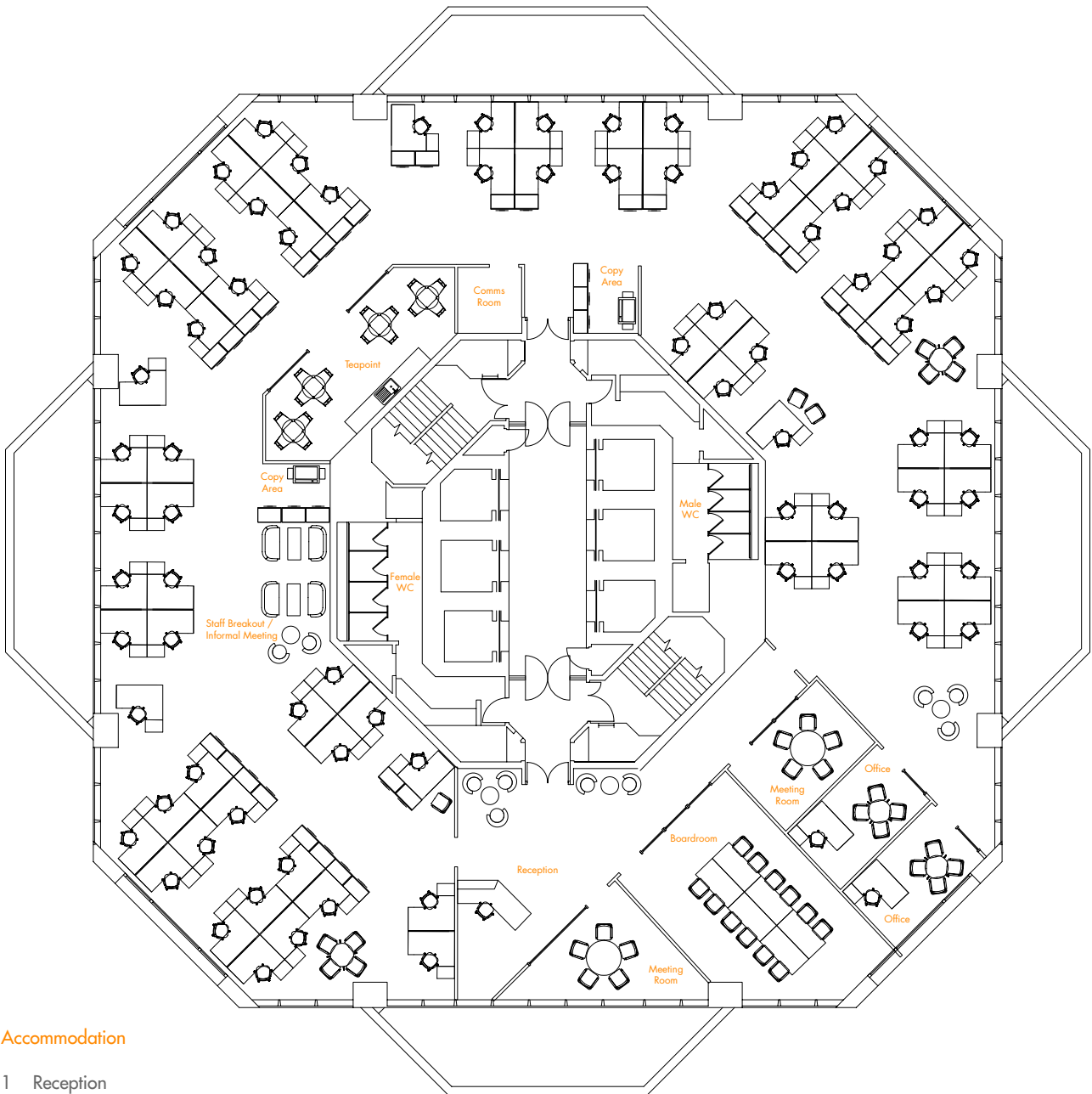

#### Accommodation

- 1 Reception
- 1 12 Person Boardroom
- 2 5 Person Meeting Room
- 2 Office
- 1 Comms Room
- 2 Copy Area
- 1 Teapoint
- 1 Staff Breakout / Informal Meeting
- 79 Open Plan Workstations

Floor plans for indicative purposes only.